



EHEIM



Industrial Catalogue

Centrifugal Pumps

Product range

EHEIM Centrifugal pumps 1000 1001 1002 1005

suitable also as				
immersion pump				●
suitable only as				
immersion pump	●	●	●	
max. temperature of media	35°C	35°C	35°C	35°C
max. output l/h	300	600	1000	270
max. delivery head Hmax m	0.5	1.3	2.0	0.75
power consumption Watt	5	11	23	4
Tubing connection				
pressure side ø mm	13	13	17	13
thread	--	--	--	--
suction side ø mm	--	--	--	17
thread	--	--	--	--
Versions				
24 V / 50 Hz				●
100 V / 50 Hz	●	●	●	
100 V / 60 Hz	●	●	●	
120 V / 60 Hz	●	●	●	
230 V / 50 Hz	●	●	●	●
240 V / 50 Hz	●	●	●	●
220 V / 60 Hz	●	●	●	
protection class	II	II	II	I
international protection	IP 68	IP 68	IP 68	IP 68



Important instructions

EHEIM centrifugal pumps have hermetically sealed motors.

All pumps may be used inside as well as outside the medium.

As the pumps are non self-priming they always have to be placed below the liquid level, submersed or outside the liquid.

All performance data are based on an operating voltage of 230 V/50 Hz and water at a temperature of 20 °C as medium. EHEIM centrifugal pumps consist of an aluminium oxyd ceramic shaft and perbunan sealing rings. All pumps can only be operated with alternating voltage. They may not run dry when in operation.

Subjects to technical modifications.

Product range

EHEIM centrifugal pumps 1046 1048 1250 1260 1262

suitable also as

immersion pump	●	●	●	●	●
max. temperature of media	35°C	35°C	35°C	35°C	35°C
max. output l/h	300	600	1200	2400	3400
max. delivery head Hmax m	1.2	1.5	2.0	3.7	3.6
power consumption Watt	5	10	28	65	80

Tubing connection

pressure side ø mm	11	13	13	18	18
thread	G 1/8"	G 1/4"	G 3/8"	G 3/4"	G 3/4"
suction side ø mm	13	13	18	28	28
thread	G 3/8"	G 3/8"	G 1/2"	G 3/4"	G 3/4"

Versions

24 V / 50 Hz	●	●	●		
100 V / 50 Hz	●	●	●	●	●
100 V / 60 Hz	●	●	●	●	●
120 V / 60 Hz	●	●	●	●	●
230 V / 50 Hz	●	●	●	●	●
240 V / 50 Hz	●	●	●	●	●
220 V / 60 Hz			●	●	●
protection class	I	I	I	I	I
international protection	IP 68	IP 68	IP 68	IP 68	IP 68



1046



1048



1250



1260

1262



EHEIM Centrifugal Pumps 1000/1001/1002



The EHEIM range of pumps is supplemented by the fully submersible range of compact pumps. Quiet, powerful, versatile with adjustable output, this range of pumps can be used in very small spaces.

EHEIM compact pumps are suitable for marine and fresh water.

3 year guarantee

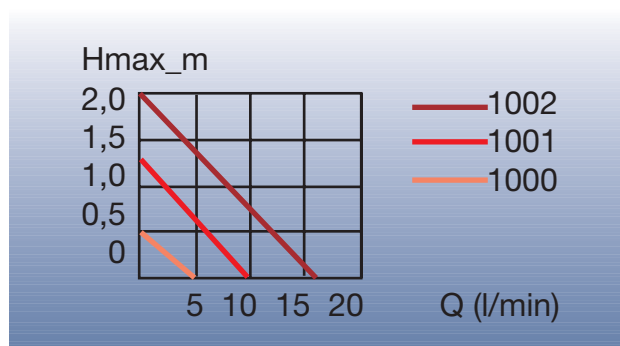
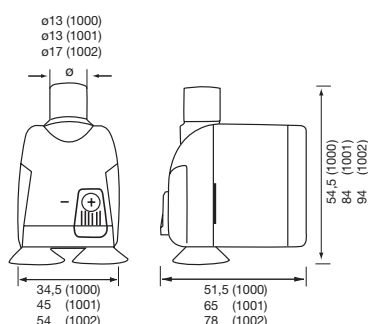

Technical Data

		1000	1001	1002
pump output	l/h	300	600	1000
delivery head	Hmax m	0.5	1.3	2.0
power consumption	Watt	5	11	23
tubing connection:	suction side	Ø	--	--
	pressure side	Ø	13	17
dimensions	mm	51.5 x 34.5 x 54.5	65 x 45 x 84	78 x 54 x 94

Spare Parts

1000

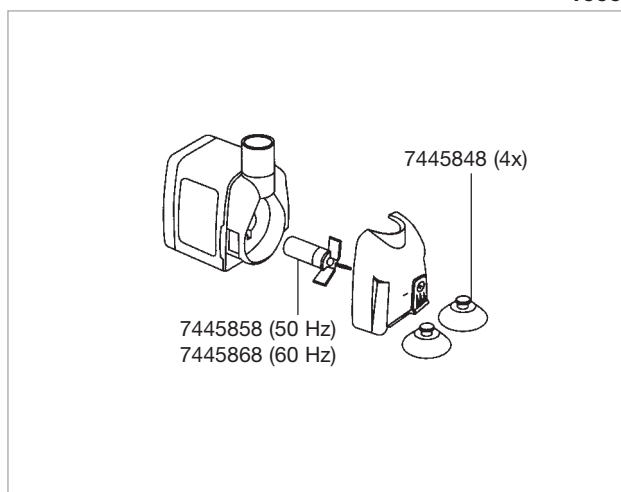

1001/1002

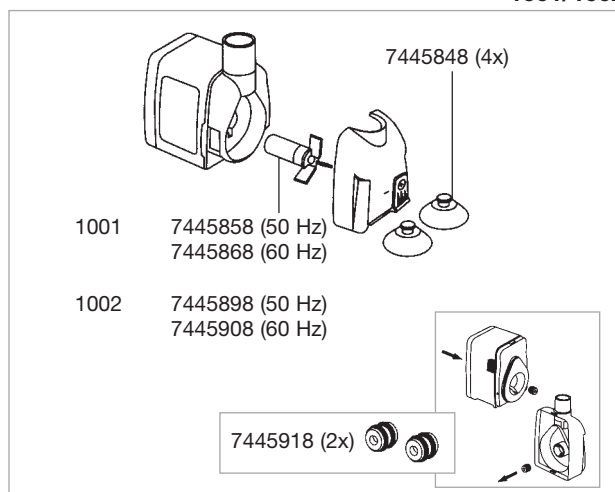

EHEIM Centrifugal Pump 1005

EHEIM
universal

Versatility and variable mounting possibilities are the distinguishing features of this compact centrifugal pump.

The bracket plate can be fixed on three sides alternatively, thus allowing either vertical or horizontal mounting.

The threaded inlet connector is rotative so that the direction of outlet can be adjusted according to requirements.

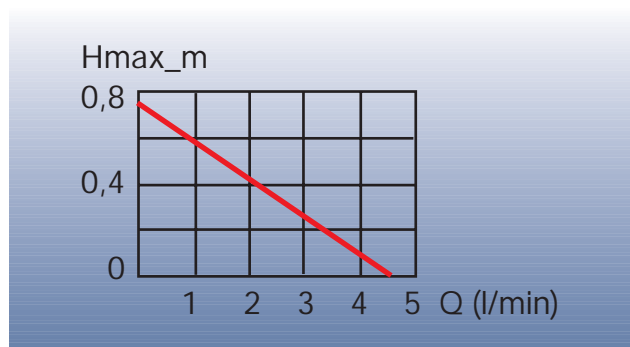
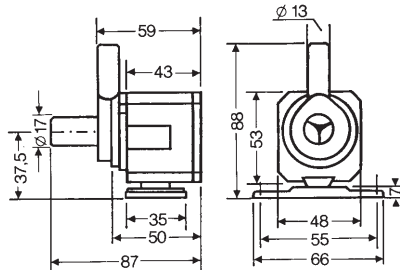
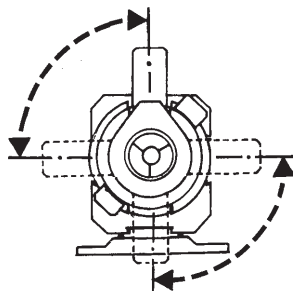

Technical Data

pump output	l/h	270
delivery head	Hmax m	0.75
power consumption	Watt	4
tubing connection: suction side	Ø	17 mm
pressure side	Ø	13 mm
dimensions	mm	87 x 66 x 88

Spare Parts

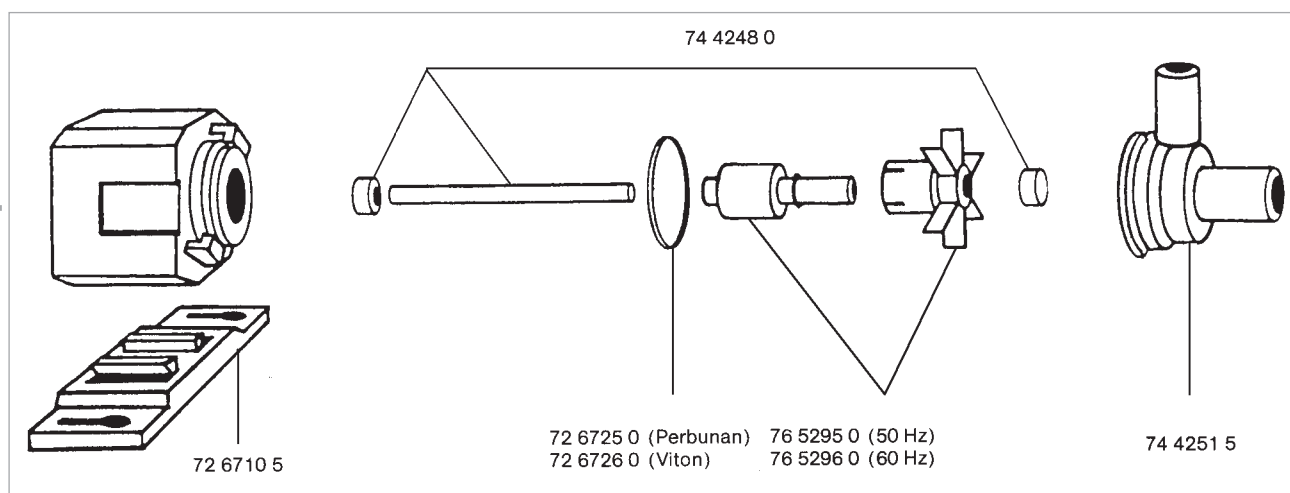

EHEIM Centrifugal Pump 1046



The important feature of this type is the variable application: The pump is suitable for in- and outside use and supplied with an integrated pre-filter.

The hermetically-sealed motor and the perfect construction guarantee permanent long-term performance for years.

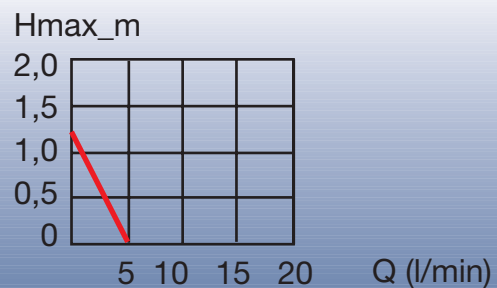
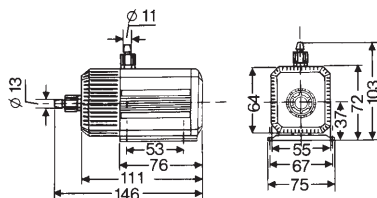

Technical Data

pump output	l/h	300
delivery head	Hmax m	1.2
power consumption	Watt	5
tubing connection:	suction side	Ø 13 mm / G3/8"
	pressure side	Ø 11 mm / G1/8"
dimensions	mm	148 x 75 x 103

Spare Parts

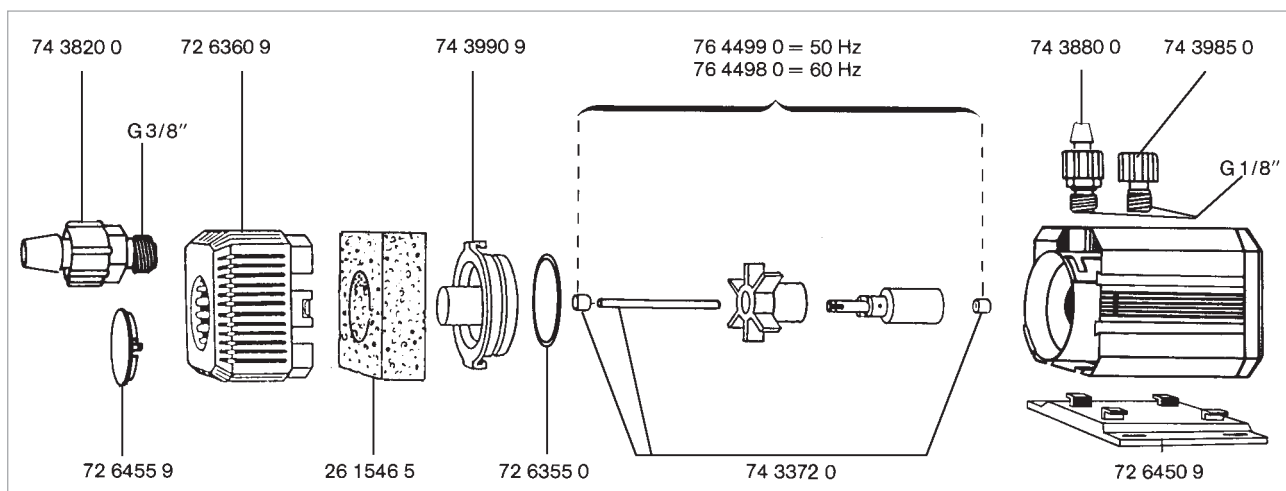

EHEIM Centrifugal Pump 1048



The universal centrifugal pump 1048 differs from the model 1046 in higher capacity and larger dimensions.

The base plate can be adjusted in three positions to enable different ways of installation.

The pump is suited for use inside as well as outside the flow medium.

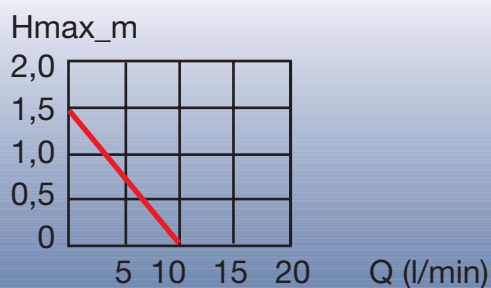
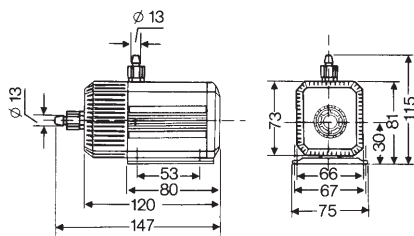

Technical Data

pump output	l/h	600
delivery head	Hmax m	1.5
power consumption	Watt	10
tubing connections: suction side	Ø	13 mm / G3/8"
pressure side	Ø	13 mm / G1/4"
dimensions	mm	147 x 75 x 119

Spare Parts

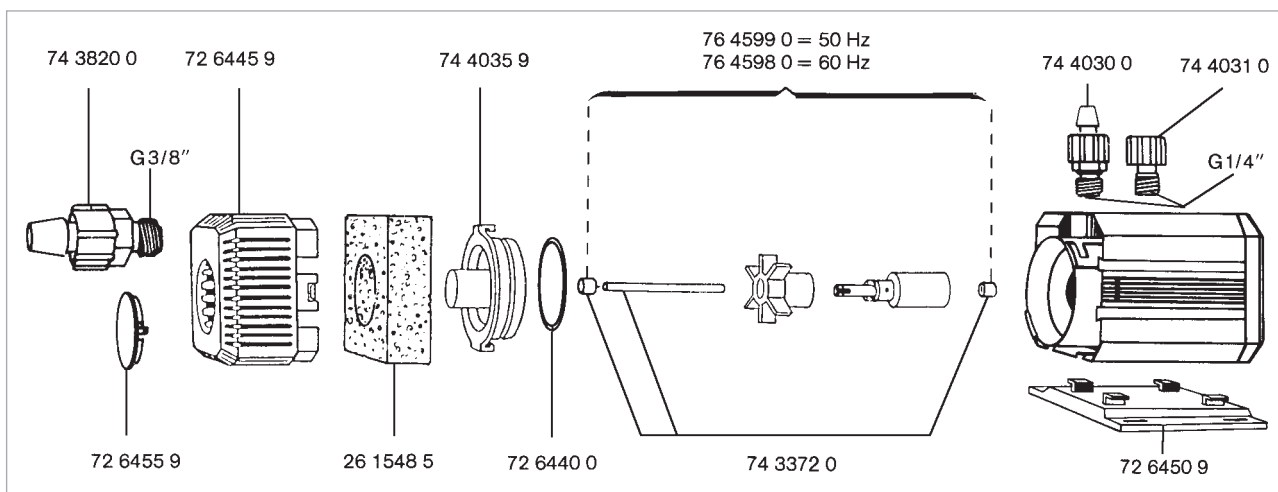

EHEIM Centrifugal Pump 1250



Universal application means: Priming via hose connection or integrated pre-filter; pressure nozzle or adapter for pipe connection - and attachable mounting strips for variable mounting. Furthermore, installation is facilitated by safe hose connections and additional hose clips. The capacity of the pump model 1250 is suited for a wide range of industrial applications.

The pump is suited for use inside and outside the flow medium.

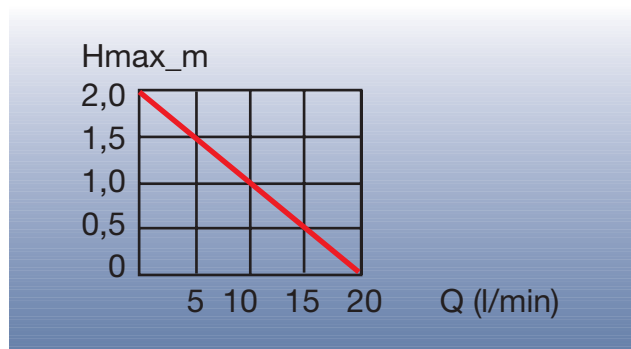
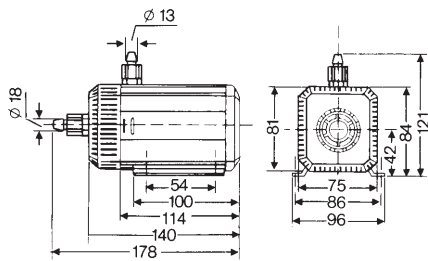

Technical Data

pump output	l/h	1200
delivery head	Hmax m	2.0
power consumption	Watt	28
tubing connection:	suction side	Ø 18 mm / G1/2"
	pressure side	Ø 13 mm / G3/8"
dimensions	mm	178 x 96 x 121

Spare Parts

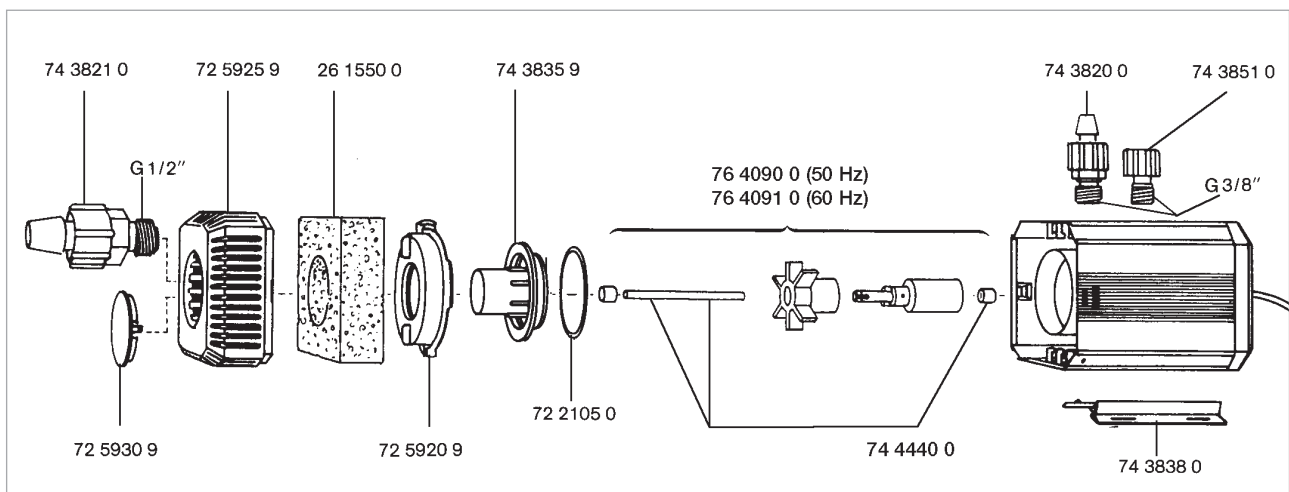

EHEIM Centrifugal Pumps 1260/1262



The range of tried and tested centrifugal pumps was extended and upgraded with the models 1260/62.

The pumps designed for constant use submerged or outside water have an integrated pre-filter, variable fixing options and an inlet connection for hose connection.

The range is supplied with 2 cable lengths (1.7m and 10m).

3 year guarantee

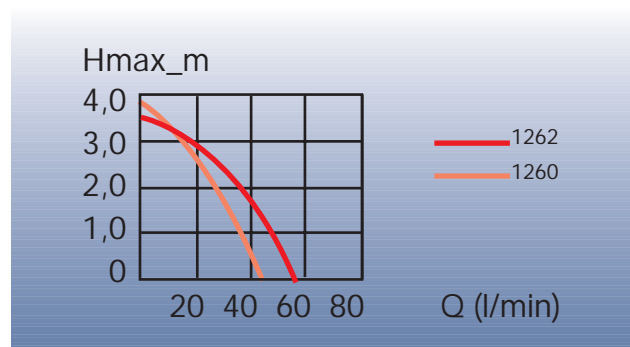
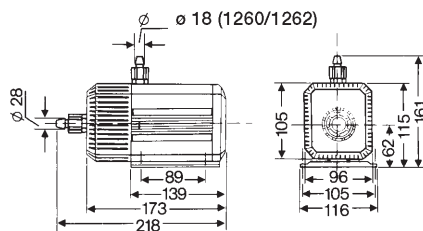







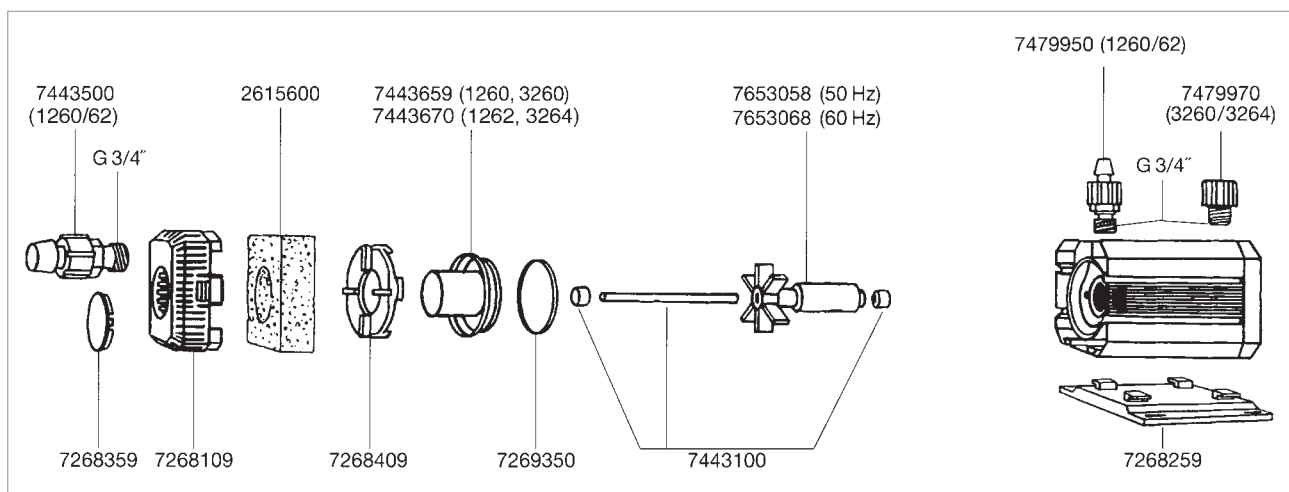



Technical Data

Technical Data			1260	1262
pump output		l/l	2400	3400
delivery head		Hmax m	3.7	3.6
power consumption		Watt	65	80
tubing connection:	suction side	Ø	28 / G3/4"	28 / G3/4"
	pressure side	Ø	18 / G3/4"	18 / G3/4"
dimensions		mm	218 x 116 x 161	218 x 116 x 161

Spare Parts



	No	article	for hose Ø
	400 2940	EHEIM quality hose (phenol-free)	4/6 mm
	400 3940	EHEIM quality hose (phenol-free)	9/12 mm
	400 4940	EHEIM quality hose (phenol-free)	12/16 mm
	400 5940	EHEIM quality hose (phenol-free)	16/22 mm
	400 6940	EHEIM quality hose (phenol-free)	19/27 mm
	400 7940	EHEIM quality hose (phenol-free)	25/34 mm
	400 3950	T-connection	9/12 mm
	400 4950	T-connection	12/16 mm
	400 5950	T-connection	16/22 mm
	400 6950	T-connection	19/27 mm
	400 7950	T-connection	25/34 mm
	400 3960	pressure control clamp	9/12 mm
	400 4960	pressure control clamp	12/16 mm
	400 5960	pressure control clamp	16/22 mm
	400 3970	hose connection (2 pcs)	9/12 mm
	400 4970	hose connection (2 pcs)	12/16 mm
	400 5970	hose connection	16/22 mm
	400 6970	hose connection	19/27 mm
	400 7970	hose connection	25/34 mm
	401 3000	elbow	9/12 mm
	401 4050	elbow	12/16 mm
	401 5100	elbow	16/22 mm
	401 6150	elbow	19/27 mm
	401 7200	elbow	25/34 mm
	400 3412	double valve with quick disconnect. coupling	9/12 mm
	400 3512	shut-off valve	9/12 mm
	400 4412	double valve with quick disconnect. coupling	12/16 mm
	400 4512	shut-off valve	12/16 mm
	400 5410	double valve with quick disconnect. coupling	16/22 mm
	400 5510	shut-off valve	16/22 mm
	400 6410	double valve with quick disconnect. coupling	19/27 mm
	400 6510	shut-off valve	19/27 mm
	400 7410	double valve with quick disconnect. coupling	25/34 mm
	400 3522	quick disconnection coupling	9/12 mm
	400 4522	quick disconnection coupling	12/16 mm
	400 5520	quick disconnection coupling	16/22 mm
	400 3530	hose clamp (2 pcs)	9/12 mm
	400 4530	hose clamp (2 pcs)	12/16 mm
	400 5530	hose clamp (2 pcs)	16/22 mm
	400 6530	hose clamp (2 pcs)	19/27 mm
	400 7530	hose clamp (2 pcs)	25/34 mm
	400 3540	suction device for all hoses	
	400 3550	cleaning brush 50 cm	9/12 mm
	401 3550	cleaning brush 100 cm	9/12 mm
	400 4550	cleaning brush 50 cm	12/16 mm
	400 5550	cleaning brush 50 cm	16/22 mm
	400 7550	cleaning brush 50 cm	19/27 + 25/34 mm
	400 3570	universal brush	9/12 mm
	400 4570	universal brush	12/16 mm
	400 6570	universal brush	16/22 + 19/27 mm
	400 9550	set cleaning brush for 1046/1048	
	400 9570	set cleaning brush for 1250	
	400 9580	set cleaning brush for 1060	